

THIS COPY HAS BEEN MADE BY OR WITH THE AUTHORITY OF RYEDALE DISTRICT COUNCIL PURSUANT TO SECTION 47 OF THE COPYRIGHT DESIGNS AND PATENTS ACT 1988. UNLESS THAT ACT PROVIDES A RELEVANT EXCEPTION TO COPYRIGHT, THE COPY MUST NOT BE COPIED WITHOUT THE PRIOR PERMISSION OF THE COPYRIGHT OWNER.

Notes	
<p>1. This drawing has been prepared by Planning Associates, 74-76, Church Street, Rye, East Sussex TN31 1JG. It is a preliminary drawing and is not to be used for any other purpose without the written consent of Planning Associates. It is the responsibility of the client to ensure that the drawing is used for the purpose intended and that it is not used for any other purpose without the written consent of Planning Associates.</p>	
Revisions	Date

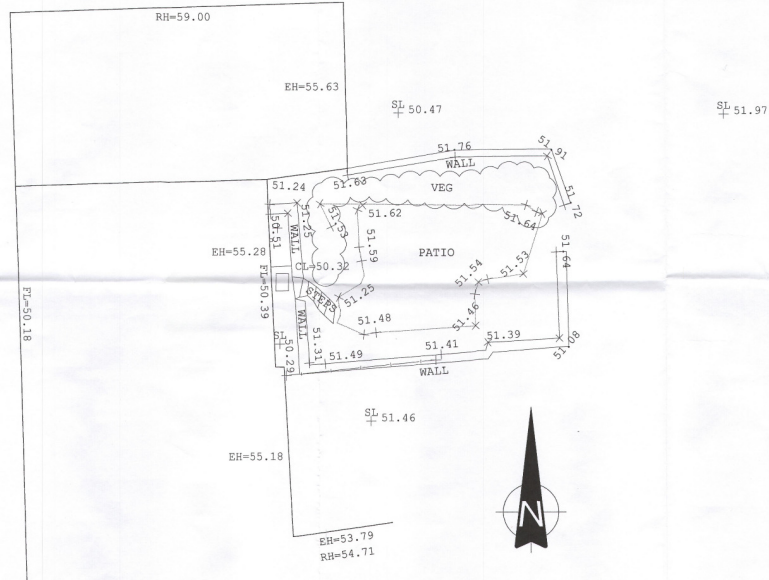

DESIGN 4 architecture Ltd	
Project	Client
24 CASTLEGATE RYE EAST SUSSEX	MRS & MRS J HUMPHREYS
Drawing	Scale
EXISTING SITE LAYOUT	1:50
Status	Date
SURVEY	NOVEMBER 2017
chadral@pcap.co.uk	01753 430763
01770 858996	

